

KR-series - Underbody cylinder



KRM 167-6-1975-152-G0399-HC

Item no.

R66639152

Tipping weight

22 ton

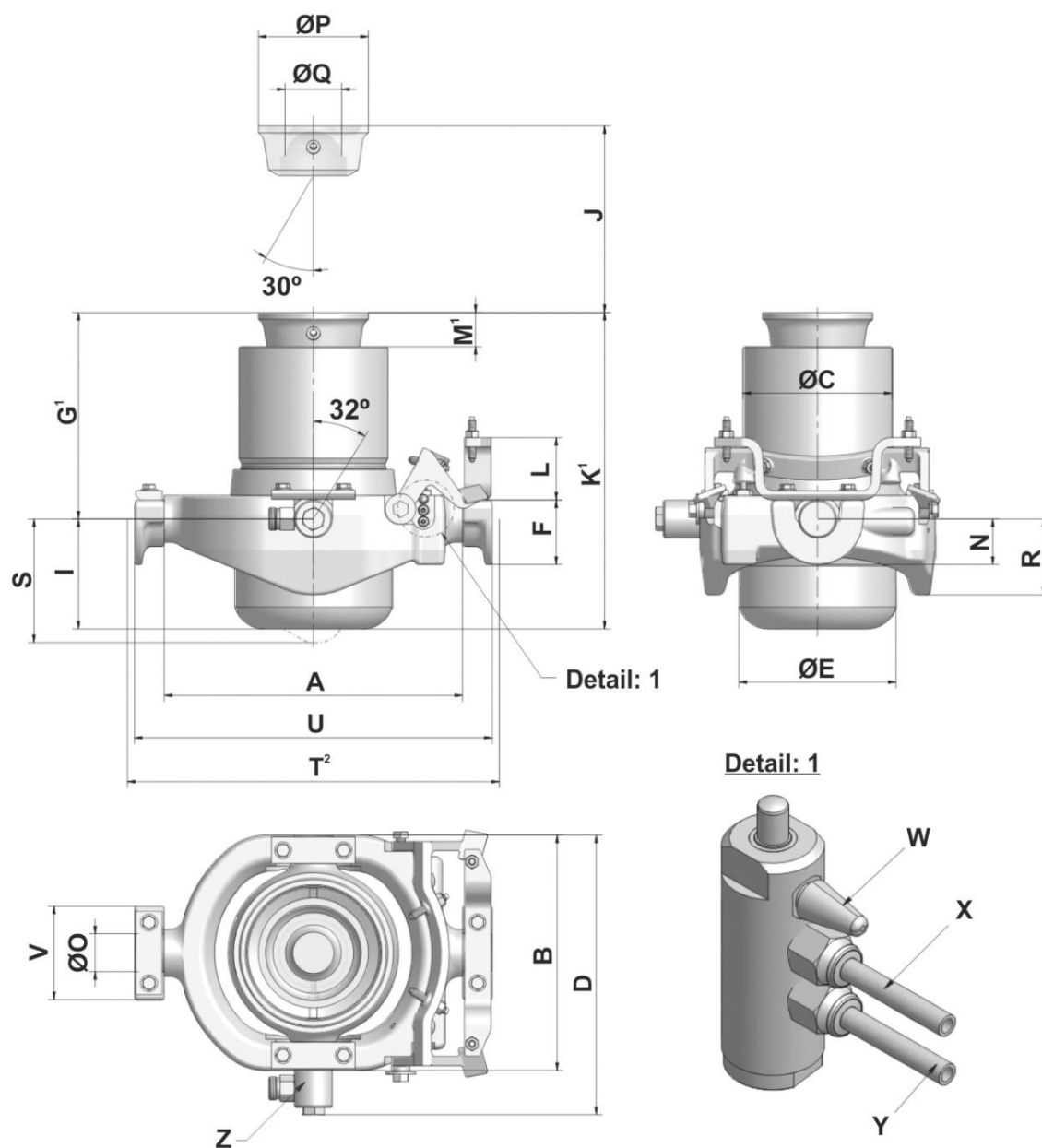

A	393	mm
B	310	mm
C	196	mm
D	370	mm
E	207	mm
F	85	mm
G ¹	399	mm
H		
I	145	mm
J	1975	mm
K ¹	544	mm
L	82	mm
M ¹	56	mm
N	60	mm
O	50	mm
P	100	mm
Q	60	mm
R	100	mm
S	163	mm
T ²	472	mm
U	471	mm
V	124	mm
W	Exhaust	
X	To tipping valve "TIP" (connection for pneumatic line 6x1)	
Y	From air control (connection for pneumatic line 6x1)	
Z	Swivelling pressure connection for tube Ø20 mm	

¹ Including 20 [-5; +30] mm pull out

² Crossbeam distance 472 [-0.5; +1] mm

3D model is available on request

Specifications

Max. working pressure	300 bar	Max. pump flow (with KO)	65 L/min	Cradle type	Cradle type 3
Total weight	147 kg	Max. pump flow (without KO)	46 L/min	Knock off type	Pneumatic
Working volume	24 L	Resulting tipping time (with KO)	22 sec		
Total volume	26 L	Resulting tipping time (without KO)	31 sec		
Max. cyl. load (start tipping)	230 kN	Allowable lowering time	22 sec		KO: Hyva knock off

Extension	1	2	3	4	5	6	7	8	9	Total
Effective diameter [mm]	167	145	125	107	090	074				
Stroke ¹ [mm]	332	338	335	326	317	329				1975

Technical notes

- This cylinder is a lifting device only.
- It should not be used as a structural member and should not be subjected to side loads.
- Tipping valve must have a pressure relief at the cylinder port set not higher than max. working pressure.
- Maximum angle of rotation during operation is 32 deg.
- Working pressure depends on the application, but must never exceed the maximum working pressure stated.
- Working temperature range is between -40°C and +80°C.
- Max. duration of extension is 0.5 hours (excluded hard chromed stages).
- Cylinder is painted black (RAL9005) with a thickness conforming to the 480 hours neutral salt spray test as per ISO 9227 (ISO10289, rating 9).

Related documentation

Bracket options: 015BRA16

Mounting instructions: CYL-0024

Oil specifications: OIL-0011

For detailed tipping calculations please refer to: <https://tipper.hyva.com>

KR-series - Underbody cylinder



KRM 167-6-1975-152-G0399-HC

R66639152

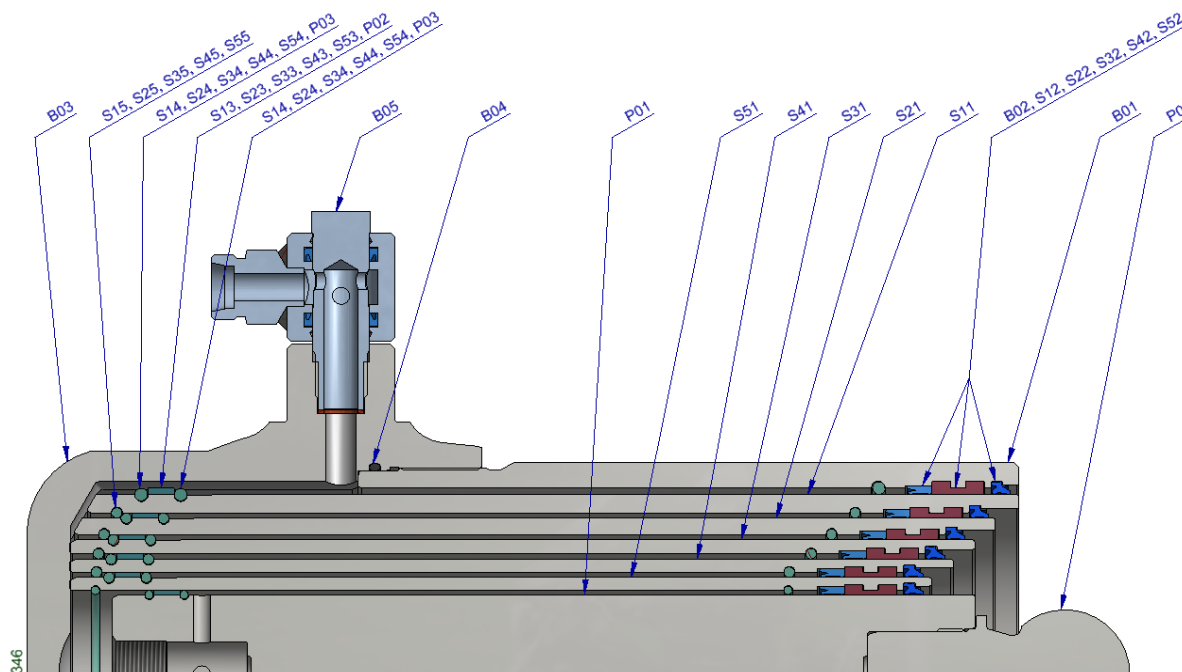

Pos.	Part no.	Description	Qty.
P01	76024281	PISTON 074-428-HC	1
P02	75018551 K	SLIDER 74x12	1
P03	G00322452 K	OUTER STOPRING 74x4	2
P04	75024160 K	SPHERE THREAD Ø60	1

S41	75944381	STAGE 107-438-K73-HC	1
S42	75412107 K	PACKSET 107 KRA/KRM	1
S43	75018549 K	SLIDER 107x12	1
S44	G00322477 K	OUTER STOPRING 107x5	2
S45	G00322471 K	LIFTRING Ø 95 X 5 MB	1

--	--	--	--

S31	75954481	STAGE 125-448-K73-HC	1
S32	75412125 K	PACKSET 125 KRA/KRM	1
S33	75018437 K	SLIDER 125x12	1
S34	G00322489 K	OUTER STOPRING 125x5	2
S35	G00322482 K	LIFTRING Ø 112 X 5 MB	1

--	--	--	--

S21	75964551	STAGE 145-455-K73-HC	1
S22	75412145 K	PACKSET 145 KRA/KRM	1
S23	75018438 K	SLIDER 145x12	1
S24	G00322498 K	OUTER STOPRING 145x5	2
S25	G03224921 K	LIFTRING Ø 130 X 5 MB	1

--	--	--	--

S11	75974601	STAGE 167-460-K73-HC	1
S12	75412167 K	PACKSET 167 KRA/KRM	1
S13	75018439 K	SLIDER 167x12	1
S14	G03225091 K	OUTER STOPRING 167x6	2
S15	G03224991 K	LIFTRING Ø 150 X 5 MB	1

S51	75934281	STAGE 090-428-K64-HC	1
S52	75412090 K	PACKSET 090 KRA/KRM	1
S53	75018550 K	SLIDER 90x12	1
S54	G03224655 K	OUTER STOPRING 90x5	2
S55	G03224535 K	LIFTRING Ø 78 X 4 MB	1

B01	75873350	BASE 193-335-K62	1
B02	75412193 K	PACKSET 193 KRA/KRM	1
B03	75018421 K	BASE BOTTOM KRM M192-A234-ZD50	1
B04	G00330987 K	O-RING 190 X 4 70 SHORE	1
B05	75419020 K	COUPLING SET R20	1

Notes

See 015BRA16 for cradle and bracket spare parts.

Seal kit complete

75420166	Consists of all packsets with packset grease and O-rings	
----------	----------------------------------------------------------	--

The inner stopring is pre-mounted in the grooves on spare stages and pistons. Therefore, when ordering new tubes, it is not required to order stoprings separately.

For repair instructions see: CYL-0034. Serial no. is located on type plate and near type plate support.