

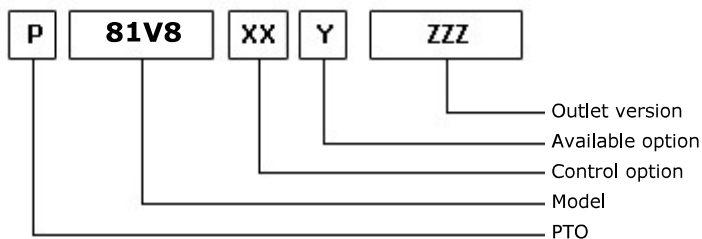

### POSSIBLE SOLUTIONS

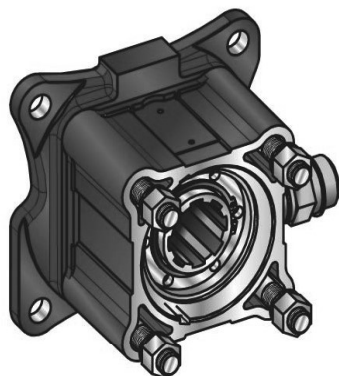

16/09/2015

### TEC. SPECIFICATIONS

|                     |                 |                    |
|---------------------|-----------------|--------------------|
|                     | <b>Outlet 1</b> |                    |
| <b>Torque (NM)</b>  | 1000            | <b>Replaces</b>    |
| <b>Int. Ratio</b>   | 1,00            | <b>Replaced by</b> |
| <b>Teeth number</b> | 12              |                    |

### CONTROL TYPE HYDROCAR

Electric      Hydraulic      Mechanic      Fixed engagement       Pneumatic      Vacuum system

### CONTROL VERSIONS (XX)

| Type | 82z1 | Description               |
|------|------|---------------------------|
| P    | 1    | #Cmd M12x1.5 con raccordo |
| P    | 2    | #Cmd M12x1.5 senza racc.  |

### AVAILABLE OPTIONS (Y)

| 82z1 | Description                | Lubr. Kit | Switch Kit  | Reinforced                          |
|------|----------------------------|-----------|-------------|-------------------------------------|
| 0    | #Non presente              |           |             | <input checked="" type="checkbox"/> |
| 4    | #Con Kit interrutt. Kostal |           | 194KSP41000 | <input checked="" type="checkbox"/> |
| 5    | #Con Kit interruttoreMERIT |           | 194KSP19000 | <input checked="" type="checkbox"/> |
| 6    | #Con Kit interruttoreTDS   |           | 194KSP40000 | <input checked="" type="checkbox"/> |



**Hydrocar®**  
*Hydraulic Energy*

# 81V8

#PTO POS. volvo vt/c

### Conversion kit

Pneumatic/Mechanic  
Mechanic/Pneumatic  
Electric control

#UNI da DIN 5462 (SE)

606X02Z0000

### Flange kit

82z1

Description

|             |                    |
|-------------|--------------------|
| 606X03F0500 | DIN 00 x PTO 0081  |
| 606X03F0600 | DIN 10 x PTO 0081  |
| 606X03F0700 | SP 1120 x PTO 0081 |
| 606X03F0800 | SP 1300 x PTO 0081 |
| 606X03F0900 | KIOKUTO "B"x 0081  |
| 606X03F1000 | SP 1400 x PTO 0081 |

### Switch kit

82z1

Description

|             |                     |
|-------------|---------------------|
| 194KSP19000 | #Merit M16x1.5 N.C. |
| 194KSP40000 | #TDS M 16x1.5 N.C.  |
| 194KSP41000 | #EATON N.C.         |



**Hydrocar®**  
*Hydraulic Energy*

# 81V8

#PTO POS. volvo vt/c

## MATCHINGS

| Brand  | Range | Model           | 1st Gear ratio | Outlet | Application |
|--------|-------|-----------------|----------------|--------|-------------|
| NISSAN |       | AO612 D 0,78    | 11,73          | Rear   | V4          |
| VOLVO  |       | AT 2412 C       | 0,00           | Rear   | V4          |
| VOLVO  |       | AT 2412 D       | 0,00           | Rear   | V4          |
| VOLVO  |       | AT 2412 E       | 0,00           | Rear   | V4          |
| VOLVO  |       | AT 2512 C       | 0,00           | Rear   | V4          |
| VOLVO  |       | AT 2514         | 0,00           | Rear   | V4          |
| VOLVO  |       | AT 2612 D       | 0,00           | Rear   | V4          |
| VOLVO  |       | AT 2612 D + IT  | 0,00           | Rear   | V4          |
| VOLVO  |       | AT 2812 C       | 0,00           | Rear   | V4          |
| VOLVO  |       | ATO 2512 C 0,78 | 11,73          | Rear   | V4          |
| VOLVO  |       | ATO 2612 D 0,78 | 11,73          | Rear   | V4          |
| VOLVO  |       | ATO 3112 C      | 0,00           | Rear   | V4          |
| VOLVO  |       | ATO 3112 D      | 0,00           | Rear   | V4          |
| VOLVO  |       | SPO 2812 0,78   | 11,73          | Rear   | V4          |
| VOLVO  |       | V 2412 AT       | 0,00           | Rear   | V4          |
| VOLVO  |       | V 2512 AT       | 0,00           | Rear   | V4          |

